

FIRST-TIME USE

Activate by connecting USB cable to power source until LEDs light up.

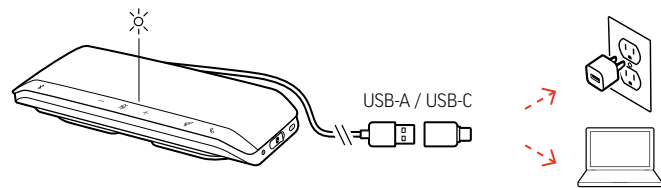

COMPUTER SETUP

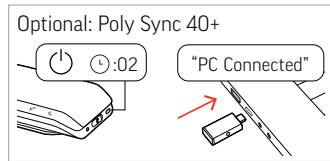
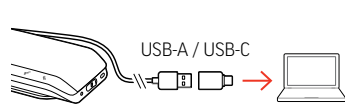

MOBILE SETUP (PAIR)

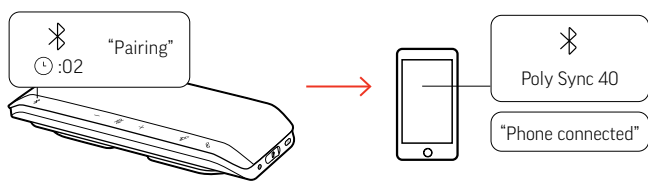

CUSTOMIZE

Configure your Rocket 🚀 button feature in Poly Lens Desktop App. Choose from play/pause music (default), device status check and more.

↓ poly.com/lens

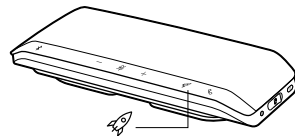

CHARGE YOUR PHONE

With your speakerphone powered on, connect your phone. Connection provides power only.

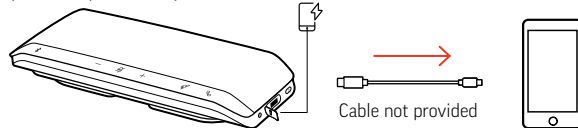

CHARGE YOUR SPEAKERPHONE

Fastest when using wall charger or computer's quick-charge port, if available.

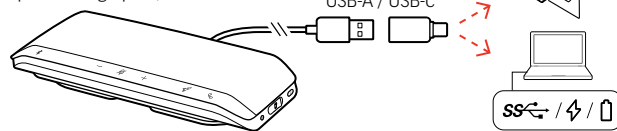

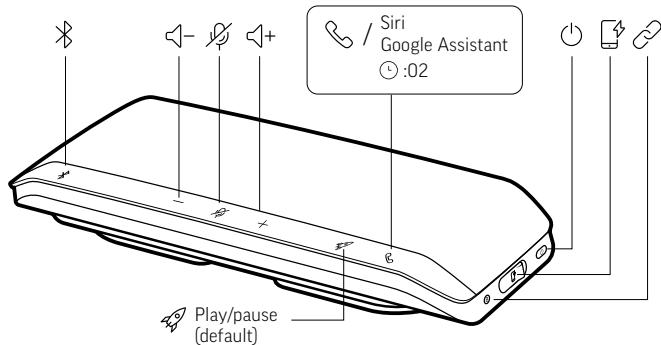

 poly.com/support

LINK SPEAKERPHONES

To wirelessly connect two Sync 40, press Link  button on both speakerphones for 2 seconds. You hear "connection successful" when linked. Pair one speakerphone to your idle mobile device to make calls or play media.

Note: Ensure your speakerphone USB cable is not connected to a computer.

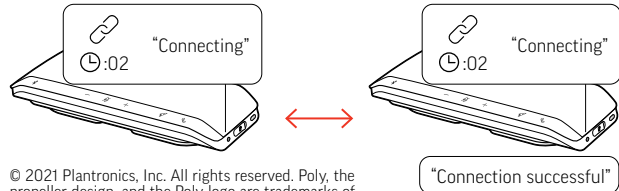

© 2021 Plantronics, Inc. All rights reserved. Poly, the propeller design, and the Poly logo are trademarks of Plantronics, Inc. Bluetooth is a registered trademark of Bluetooth SIG, Inc. and any use by Plantronics, Inc. is under license. All other trademarks are the property of their respective owners. Manufactured by Plantronics, Inc.
215633-04 Rev C 04.21 Model ID: SY40/SY40-M (may be followed by /BT600)



Recyclable where facilities exist



QUICK START

POLY SYNC 40 SERIES